

SPECIFICATION



technical details

according to ISO 8666

LOA	11.95 m TBC	39' 2"
Hull length	11.56 m	37' 11"
Beam	3.87 m	12' 8"
Draft max	0.83 m	2' 9"
Water tank	200 l	44 UK gal
Fuel tank	1.140 l	251 UK gal
Displacement	8.02 t	7.89 UK t
CE Category	B	B
Max. persons	12	12
Engine Option		
2 Mercury Verado V10 400 hp	approx.	42 kn.*



*Max. outboard horse power: 2x 400 hp, max. speed allowed: 45 knots - Cat D sea state . These figures cannot be guaranteed as top speed in particular is affected by the cleanliness of the hull, conditions of the propellers, weight carried and air/sea temperature. Performance is related also to the optional accessories selected."TBC" stays for: To Be Confirmed. FJORD reserves the right to change specifications in line with the company policy of improvement through research and development. All measurements/figures approximate. Errors and omissions are excepted. Specification and material can be changed without notice. Please check with your dealer for a full list of inclusions. Valid from 2025.11.05

EXTERIOR LAYOUTS

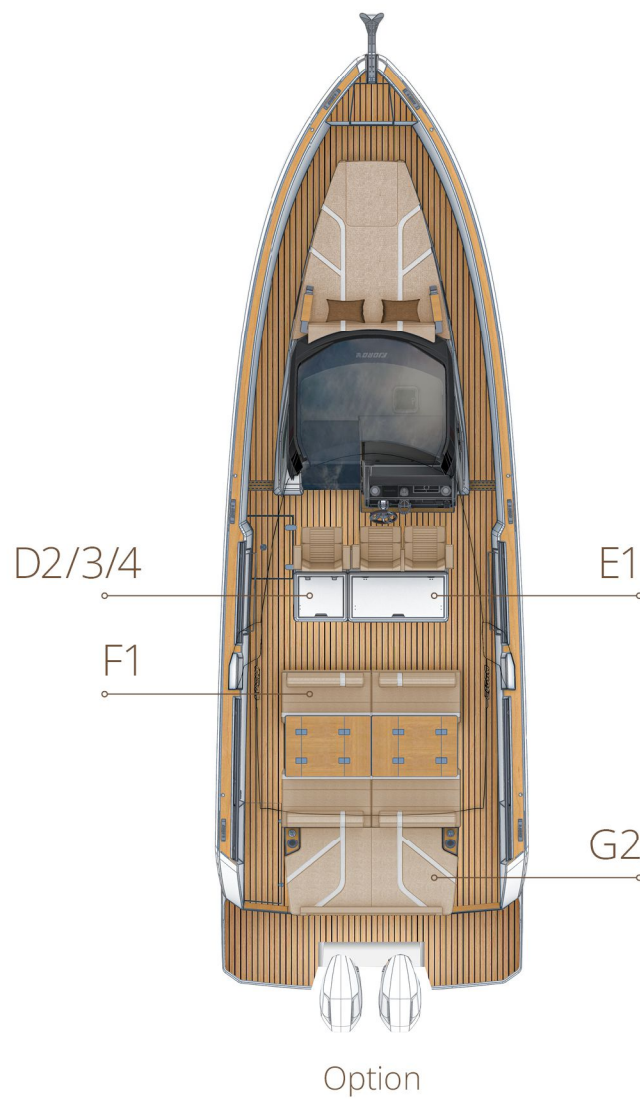

INTERIOR LAYOUTS

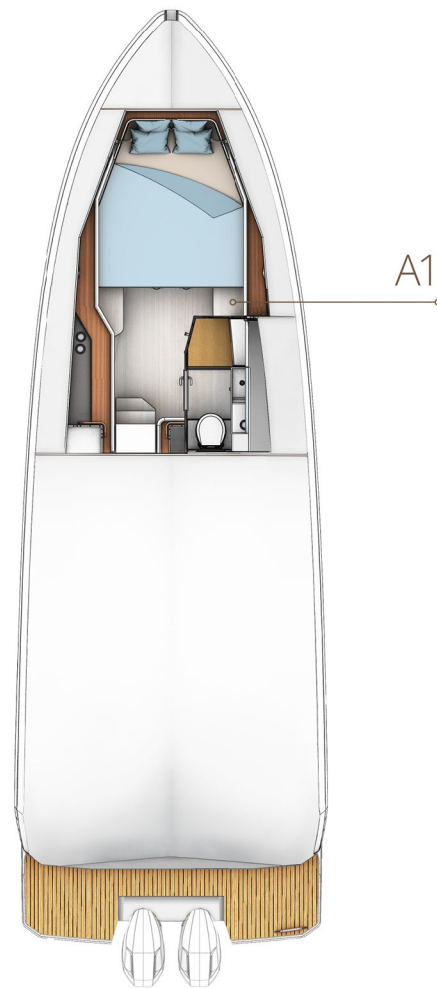

Standard

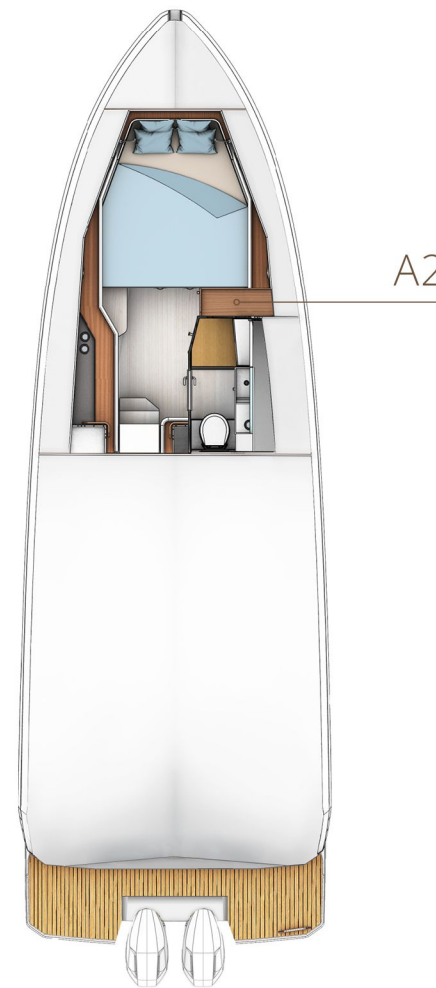

Option

STANDARD EQUIPMENT

HULL

- / GRP hull, isophthalic gelcoat, colour: signal white (according to colour card), 1st layer vinyl ester resin
- / Waterline, isophthalic gelcoat, colour: jet black (according to colour card)

DECK & COCKPIT

- / Dashboard, colour: signal white (according to colour card), with foot support, handrail and switch panel
- / GRP deck, isophthalic gelcoat, colour: signal white (according to colour card), 1st layer vinyl ester resin. Self draining anchor locker. Anchor arm in stainless steel. Stainless steel tie bar for fender. Large diameter stainless steel handrails, gunwale in GRP. Sunpad at bow with upholstery on top.
- / Synthetic teak on deck and 2 side bathing platforms (according to colour card)
- / FJORD steering wheel with tilting system
- / 4 openable portholes (2 in cabin, 2 in toilet)
- / Windshield, open at the top
- / 2 side bathing platforms with telescopic bathing ladder, integrated in bathing platform
- / 1 manual deck hatch in cockpit for access to storage room and 1 to technical compartment
- / 6 aluminium mooring cleats, stainless steel handrails
- / Shower unit with hot and cold water
- / Pilot and 1 copilot seat, fixed

PROPULSION

- / Fuel tank, capacity: 1.140 litres, fuel filter

ELECTRICAL EQUIPMENT

- / 12 V and 230 V electric system with 230 V shore power connection. Sockets in cabin (3), toilet (1), storage room (1) and 12V on dashboard (1)
- / Engine battery preparation, incl. main switches
- / Batteries-Service: 1 x 160 Ah AGM
- / Country Version: EU / AUS
- / Manual toilet
- / Spotlights and indirect lights in cabin and toilet. Light in storage room.
- / Holding tank, capacity: 60 litres
- / Water tank, capacity: 200 litres
- / Hot water boiler and pump
- / Bilge pumps: automatic electric (2) and manual emergency bilge pump in cockpit (1)

LAYOUT & INTERIOR

- / A1: Cabin with double berth, fridge and storage on p side. Fully equipped head with separated shower.

EXTERIOR MODULES

- / D1: Free deck
- / E1: Pilot and copilot seat with galley module sb side, sink with folding mixing tap and storage, working top in marine mineral stone.
- / F1: 2 benches with convertible backrests and upholstery on top
- / G1: Free deck with wired guard rail at stern

UPHOLSTERY & WOOD

- / Covered mattress scheme: porto bello, colour: cream (according to colour card)
- / Exterior upholstery and helmsman seats - Hitch, colour: Starfish (according to colour card)
- / Interior furniture in high quality marine plywood, colour: warm mahogany (according to colour card)
- / Decor elements on p side - colour: black (according to colour card)
- / Fiddle on p and s side - colour: white (according to colour card)
- / Toilet door, vertical furniture surface on p side and front of the bed in white HPL
- / Ceiling in fiberglass, colour: white
- / Floorboard - pale acacia (according to colour card)

TRANSPORT

- / Identified locations for hand held fire extinguishers - (hand held fire extinguishers are not supplied), FJORD Owner's Manual in FJORD document bag